

# ASSEMBLY INSTRUCTIONS

## TIPS:

Review assembly instructions before starting  
Work on a soft, clean surface  
Remove protective film prior to assembly

## INCLUDED

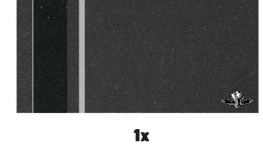
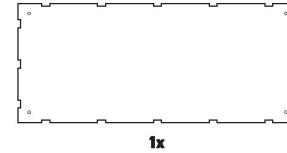
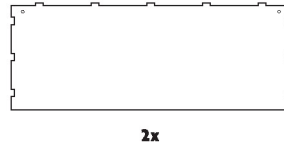
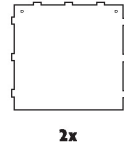
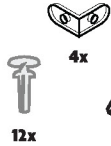

- #1** Place reversible insert on base  
*\*Optional - For gloss black base, skip this step*

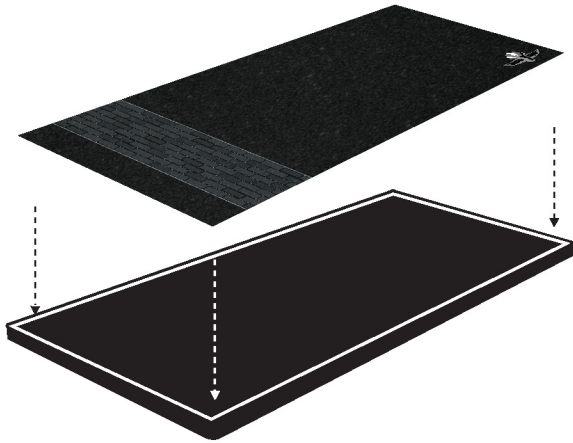

- #2** Assemble all four sides before continuing

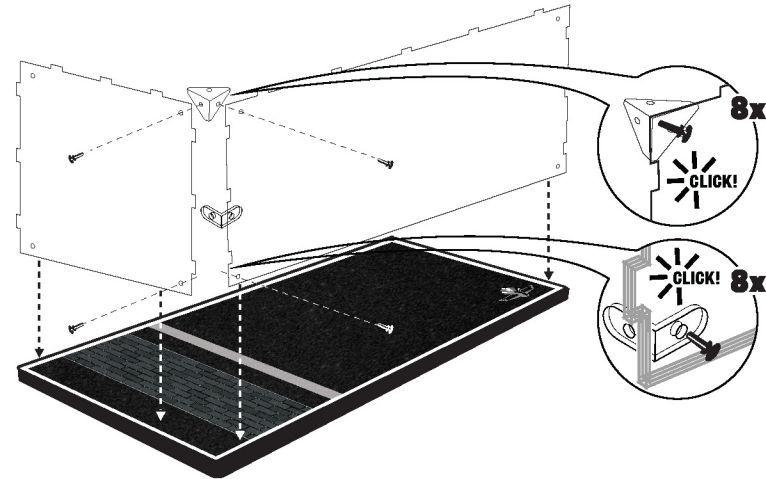

- #3** *\*Optional - For top access, don't pin top.*

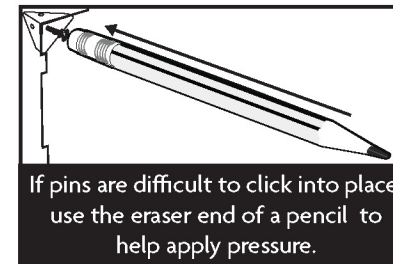
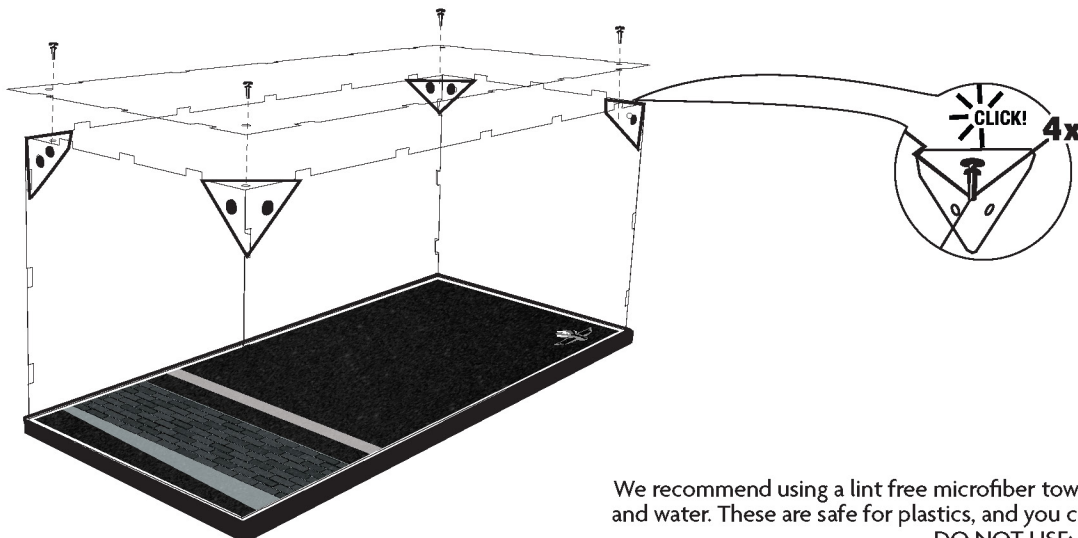

**CLEANING AND MAINTENANCE:**  
We recommend using a lint free microfiber towel. We recommend Brilliance or Novus. You can also use a solution of mild dish soap and water. These are safe for plastics, and you can even purchase solutions that help minimize the appearance of any scratches.  
**DO NOT USE:** Ammonias, All Purpose Cleaners, Abrasives, Dry Cloths, Aromatic Cleaners, Windex